



WINDOW TECHNOLOGY  
DOOR TECHNOLOGY  
AUTOMATIC ENTRANCE SYSTEMS  
BUILDING MANAGEMENT SYSTEMS



FOR PVC, TIMBER AND ALUMINIUM WINDOWS AND BALCONY-DOORS



## The Tilt&Turn hardware range UNI-JET

Securing technology for you



# Securing technology for you

The hardware world of the GU Group .....	4
For universal use: the UNI-JET central locking system .....	6
The face-fixed UNI-JET hinge-sides.....	10
The concealed UNI-JET hinge-sides .....	12
The UNI-JET Tilt&Turn hardware range .....	14
Hardware systems for PVC.....	16
Hardware systems for timber .....	18
Hardware systems for aluminium .....	21
Systematic service .....	28

## Copyright notice

© All illustrations and texts in this publication are protected by copyright. Unless otherwise stated on the image, the rights belong to the Gretsch-Unitas Group. Any use of copyright protected materials without the consent of the holder of the rights is prohibited.

## Image credits

Page 3 With kind permission of kab planungsbüro für bauleistungen gmbh, Fellbach

## Publisher

Gretsch-Unitas GmbH Baubeschläge  
Johann-Maus-Str. 3 | 71254 Ditzingen, Germany  
Tel. + 49 7156 301-0 | Fax + 49 7156 301-293  
[www.g-u.com](http://www.g-u.com)

Hardware for windows and balcony-doors must do so much more than just function correctly. Only those who also actively acknowledge the importance of aesthetic design, ease of installation and efficient warehouse storage can really deliver an efficient solution. This is why window manufacturers rely on the Gretsch-Unitas group: as one of the leading international providers of window and door technology as well as automatic entrance door and building management systems, we are also the competent partner for Tilt&Turn hardware. The basis is the 100-year history of our family-owned company which has always been intrinsically linked with technical progress, reliability and efficiency. With our Tilt&Turn hardware range we provide an aesthetically attractive, universally applicable, complete solution. In order to live up to our guiding principle "Securing technology for you", we combine first-class products with first-class services which we would like to present in this brochure.



© kab GmbH Fellbach

The Gretsch-Unitas group: a traditional family-owned company for more than 100 years

Securing technology for you



## Keep all your options open.

Side-Hung, Inline-Sliding, Top-Hung, Tilt-Only, Vertical-Pivot or Slide&Fold windows. Single or multi-sashed in different shapes. Made of PVC, timber and aluminium. The GU Group provides all options to window fabricators all over the world and also makes their job equally straightforward: by supplying high-quality hardware systems that not only satisfy high technical and aesthetic demands, but also increase fabrication, installation and storage efficiency.







# For universal use: the UNI-JET central locking system



### One solution fits all – the central locking system principle

With the central locking system, the GU Group supplies a hardware system which can be used universally for all window shapes, whether for PVC, timber or aluminium windows with a 16 mm sash groove: from Tilt&Turn windows to Horizontal-Pivot and Vertical-Pivot windows through to Tilt&Slide and Fold&Slide balcony-doors. Special shapes, such as round-arched, basket-arched and pointed-arched windows are possible using a small number of additional components.

### Efficient storage, manufacturing and installation

As the central locking system can be used universally, different hardware systems are no longer required during manufacturing: this reduces the expenditure for storage and reordering and simplifies installation. As the system requires comparatively few hardware components, which can be flexibly used in different opening types, this not only guarantees easy installation but also reduces the number of individual components to a minimum.

### Integrated security benefits

In addition to opening and closing conveniently, window hardware is also required to satisfy another important criterion – burglar resistance. The design of the central locking system is always the same irrespective of the required security – from basic security through to the tested burglary resistance classes RC1 N, RC2 N and RC2. The configuration of burglar resistance classes is determined most importantly by the selection of different strikers.



## THE CENTRAL LOCKING SYSTEM PRINCIPLE

One solution for all window types and materials. Special central locking systems are only required for the Lift&Slide systems and with ALU-JET AK 8.



Tilt&Turn window



Horizontal-Pivot window



Vertical-Pivot window



Tilt&Slide window / balcony-door



Parallel-Slide window / balcony-door



Fold&Slide window / balcony-door



# Well thought out down to the last detail: the UNI-JET central locking system



## From automatic cams through to anti-slam devices

Ingenious technical solutions that can be combined to form an intelligent system: all components of the central locking system are precisely coordinated and have been developed with the aim of simplifying manufacturing, installation and operation.



### Cleverle

The Cleverle automatic cam compensates for clearances of between 8.5 and 15 mm in conjunction with the standard striker, simplifying installation and maintenance.



### Clip connection

The drive-gear and stay-guide's connection is implemented both safely and practically, thanks to the clip-in function.



### Linear, automated-machinery compatible connection

Build windows cost-effectively: the linear connection simplifies automated-machinery fabrication.

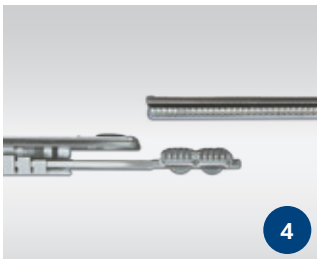

### Straight(forward) cropping

Easily crop drive-gears and stay-guides to the required length – no special staggered punching machinery required: also ideally suited for subsequent cutting on site.

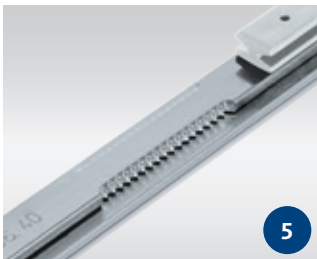

### Fixed handle height drive-gear

Ideal for modular connections: the fixed handle height drive-gear can be cropped by 160 mm to accommodate other hardware components.



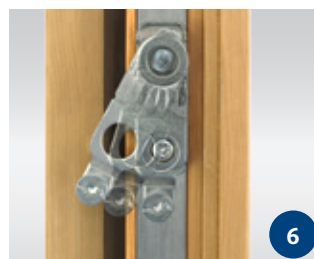

### Sash lifter

The sash lifter gently lifts the sash into the locked position. The sash lifter gently lifts the sash into the closed position, supporting user-friendly operation and preventing mishandling.



### Logo clip

The logo clip is suitable for the application of CE and RC2 markings or fabricator logos and addresses.

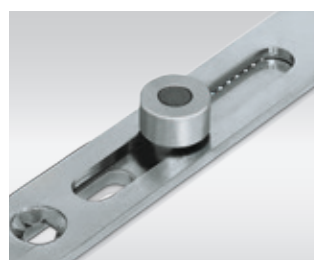

### Magnetic contact

Various components incorporating magnets are available for opening & locking monitoring up to VdS grade C.



### Standard ferGUard\*silver surface sealing

Enduring high-quality aesthetics: ferGUard\*silver is highly resistant to corrosion as verified by the results of standardised salt spray tests.



### faceGUard – surface treatment for the highest demands

The surface treatment for protection against aggressive climatic conditions, e.g. in coastal regions. Meets the requirements of the stringent salt spray test for up to 1500 hours.



### Flat packaging

UNI-JET is supplied in ergonomic flat packaging which makes installation easier and saves warehouse space.

# The face-fixed UNI-JET hinge-sides







### The face-fixed UNI-JET D, UNI-JET M, UNI-JET S and UNI-JET C hinge-sides

Aesthetics and slimline features in window design are becoming more and more important. The technical demands are also increasing: the emergence of trends such as triple glazing and floor-to-ceiling windows mean that greater sash weights are required. With UNI-JET, the GU Group provides a range of hinge-sides that satisfies these design and technology expectations – irrespective of whether for PVC, timber or aluminium windows.

#### Tried-and-tested technology with an appealing look

The UNI-JET hinge-side is convincing due to its cohesive elegant design which blends harmoniously with modern window frames: the high-quality surface in white paint or silver aesthetics has no visible screws or pins, which means cover caps are no longer required. Additional colours are available on request or choose from the wide range of cover caps available.

#### The lasting effective solution

The UNI-JET can carry sash weights up to 200 kg and floor-to-ceiling sashes up to a height of 2800 mm – without requiring any additional components and with identical visual appearance. Ease of movement when opening and closing is also ensured up to the safety class RC3. The hardware functions are guaranteed for 10 years, ensuring their long term reliability.

#### Easy handling in production

The entire UNI-JET hardware range is designed for easy, efficient and machine-compatible fabrication. Symmetrical components, hole and screw patterns make hardware installation easy. Flat packagings and a reduced number of components save warehouse space.

#### Product overview

Description	PVC			Aluminium	
	UNI-JET D	UNI-JET M	UNI-JET S	UNI-JET D	UNI-JET C
Description	D = drilled	M = milled	S = screwed	D = drilled	C = clamped
Sash rebate width (mm)	280 – 1600	280 – 1700	280 – 1600	280 – 1600	280 – 1600
Sash rebate height (mm)	280 – 2800	280 – 2800	280 – 2800	280 – 2800	280 – 2800
Tested hardware load-bearing capacity (kg)	150	200	130	100	130
Page	16	18	18	22	21

For all stated weights and dimensions, please refer to our application diagrams. For more information: [www.g-u.com](http://www.g-u.com)

# The concealed UNI-JET hinge-sides





## The concealed UNI-JET SCF and UNI-JET CC hinge-sides

The GU Group provides a wide range of concealed hinge-sides for PVC, timber and aluminium windows in order to meet high design expectations and extend the scope of window design and manufacturing freedom. The fully concealed hinges make the window profiles a visual highlight.

### No compromises on design and functionality

The UNI-JET SCF hinge-side for PVC and timber windows (with/without overlap or with CONTURA-compatible profile) and the UNI-JET CC hinge-side for aluminium windows emphasise clear architectural lines and offer the same degree of safety and functionality as the face-fixed hinge-sides from the GU Group.

### The invisible load carrier

Sash weights up to 160 kg, floor-to-ceiling sashes up to 2800 mm and ease of operation, also in safety classes up to RC2 – the concealed hinge-sides have been found to perfectly satisfy all of the above when subjected to 15,000 test cycles. The option of a barrier-free version provides an additional benefit.

### More installation efficiency

With concealed hinge-sides, the sashes are hinged parallel to the frame. This allows for one-man installation. Space-saving packaging and a reduced number of components also reduce storage overheads.

### Product overview

Description	PVC	Timber	Aluminium
Tilt&Turn hardware	UNI-JET SCF	UNI-JET SCF	UNI-JET CC
Description	S = screwed C = concealed F = flush	S = screwed C = concealed F = flush	C = clamped C = concealed
Sash rebate width (mm)	390 – 1400	390 – 1400	390 – 1400
Sash rebate height (mm)	350 – 2800	350 – 2800	350 – 2800
Tested hardware load-bearing capacity (kg)	160*	160*	130
Page	17	18	23

\* 160 kg with optional load-absorption set  
For all stated weights and dimensions, please refer to our application diagrams. For more information: [www.g-u.com](http://www.g-u.com)

# The full product range.

PVC, timber or aluminium; face-fixed or concealed hinge-side: each window places specific demands on the hardware. The UNI-JET Tilt&Turn hardware range thankfully offers the right solution for all windows and balcony-doors – aesthetically pleasing, high-quality and easy to manufacture.



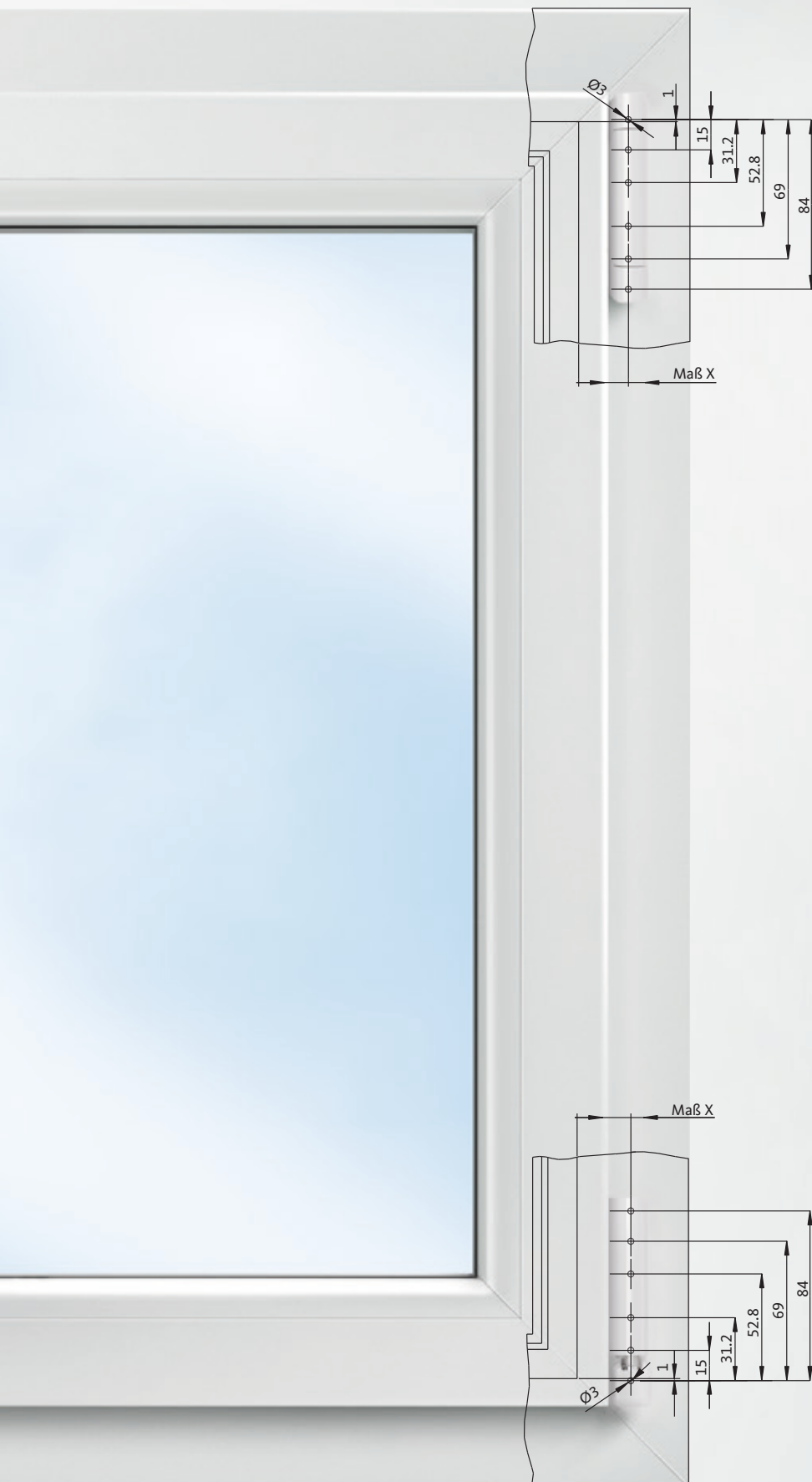

**Drilling jig for pivot-rest and stay-bearing**

Perfect positioning of each hinge-side: the symmetrical solid drilling template makes installation easier and prevents installation errors.



**Drilling-jig for drill-in hinge**

The solid drilling jig with funnel-shaped drill bushings of hardened steel allows the sash to be pre-drilled efficiently and precisely.

# The face-fixed hardware system for PVC

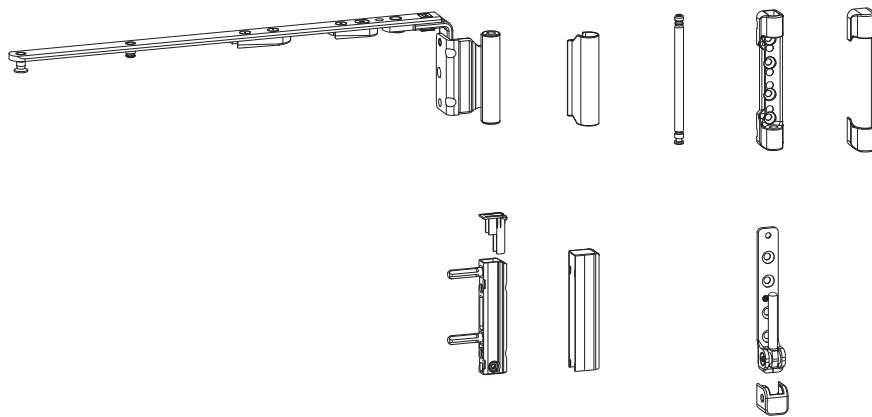

## UNI-JET D

The UNI-JET D hinge-side is available for PVC windows and balcony-doors either with a rebate corner-hinge or drill-in hinge. The strikers are perfectly adapted to the particular profile system and ensure the window elements work reliably.

### Design benefits

- Cohesive elegant design
- High-quality surface available from stock in white and silver, additional colours available on request
- Cover caps available in a large selection of colours

### Easy handling

- Assembly-friendly pin safeguard in the stay-bearing
- Convenient, three-dimensional hardware adjustment
- Easy adjustment without having to remove anything: flexible cap on the bottom drill-in hinge or rebate corner-hinge
- Stay bearing pin can be conveniently removed using the GU pull-handle or the GU adjustment tool, or a standard slotted screwdriver

### Possible applications

- Load-bearing capacity of hardware tested up to 150 kg
- Barrier-free version with higher positioned rebate corner-hinges for balcony and patio doors with threshold



Rebate corner-hinge



Flexible cap



Drill-in hinge



Stay-bearing and pivot-rest

### Product overview

Description	Clearance [mm]	Axis [mm]	Sash overlap width [mm]	Tested hardware load-bearing capacity [kg]	Max. sash rebate width [mm]	Max. sash rebate height [mm]	Version of pivot-rest with positioning pin [mm]
UNI-JET D	12	9 / 13	18 / 20 / 22	150	1600	2800	3 mm and 6 mm Ø in diff. lengths

For all stated weights and dimensions, please refer to our application diagrams. For more information: [www.g-u.com](http://www.g-u.com)



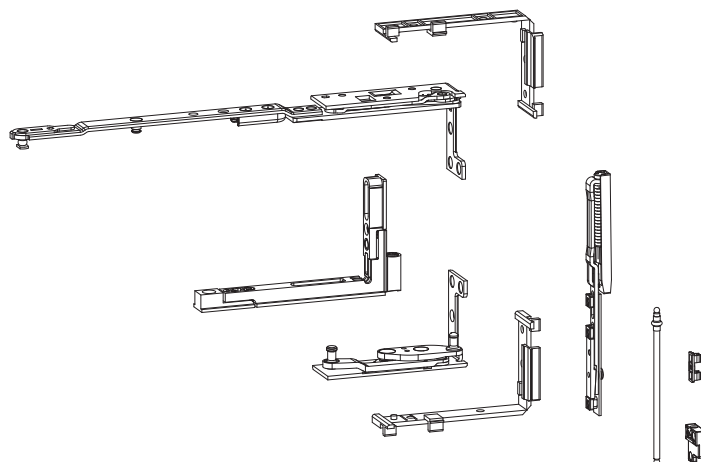

## UNI-JET SCF

The PVC hardware for windows and balcony-doors with fully concealed pivot-rests and stay-arms satisfies the most stringent demands in terms of design, user friendliness and ease of installation.

### Design benefits

- The new inward-moving turning-curve allows for greater design freedom
- No visible hardware components – also suitable for use in flush windows

### Easy handling

- No window drilling required
- One-man installation possible thanks to the parallel sash hinging
- No damage to components when plastering, as they are situated in the rebate area

### Possible applications

- Also with triple sashed "Swiss windows"
- Hardware load-bearing capacity tested up to 130 kg, with load-absorption set up to 160 kg
- Opening angle up to 90°
- Tested resistance classes



Interior view



Stay-arm



The new UNI-JET SCF with new inward-moving turning-curve

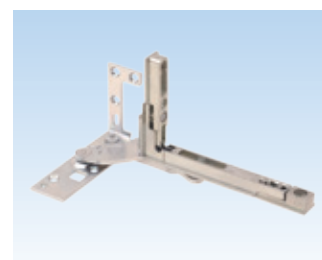

Pivot-rest

### Product overview

Description	Clearance [mm]	Axis [mm]	Sash overlap width [mm]	Tested hardware load-bearing capacity [kg]	Max. sash rebate width [mm]	Max. sash rebate height [mm]
UNI-JET SCF	12	9 / 13	max. 22	130	1400	2800
UNI-JET SCF	12	9 / 13	max. 22	160*	1400	2800

\* 160 kg with optional load-absorption set

For all stated weights and dimensions, please refer to our application diagrams. For more information: [www.g-u.com](http://www.g-u.com)

# The face-fixed hardware systems for timber

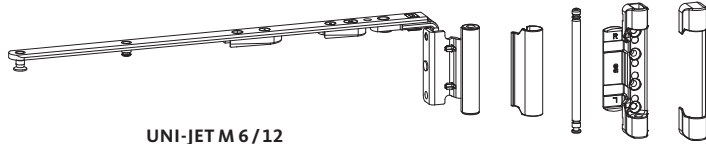

UNI-JET M 6/12

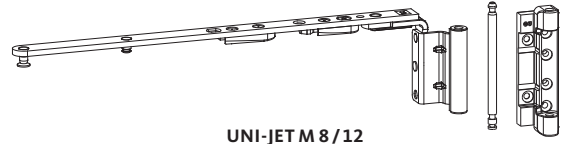

UNI-JET M 8/12

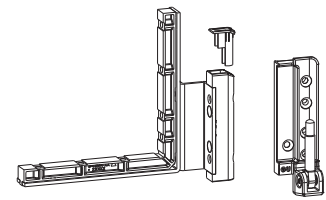
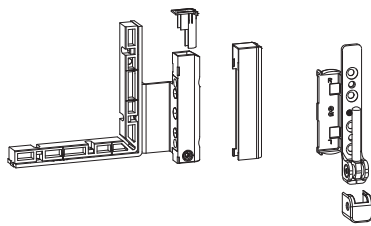

## UNI-JET M and UNI-JET S

For timber windows and balcony-doors, UNI-JET M and UNI-JET S offer a wide range of hinge-side versions from 1 x Ø34mm and 2 x Ø34mm drill-hole through to the screw-on type pivot-rest and stay bearings.

### Design benefits

- Cohesive elegant design
- High-quality surface available from stock in white and silver, additional colours available on request
- Cover caps available in a large selection of colours

### Easy handling

- Assembly-friendly pin safeguard in the stay-bearing
- Convenient three-dimensional hardware adjustment
- Easy adjustment without having to remove anything: flexible cap on the bottom rebate corner-hinge
- Stay bearing pin can be conveniently removed using the GU pull-handle or the GU adjustment tool, or a standard slotted screwdriver

### Possible applications

- Sash rebate up to 1700 mm wide and 2800 mm high
- Maximum hardware load-bearing capacity is 200 kg due to solid rebate corner-hinges for heavy weights with identical aesthetics as with the standard hinge-side version
- Barrier-free version with higher positioned rebate corner-hinges for balcony and patio doors with threshold
- All versions are also available as Tilt-First system
- Rebate corner-hinges available with or without turn-brake (turn restriction)

### Product overview

Description	Clearance [mm]	Axis [mm]	Sash overlap width [mm]	Tested hardware load-bearing capacity [kg]	Max. sash rebate width [mm]	Max. sash rebate height [mm]
UNI-JET M20/12	12	9	18 / 20	130	1600	2800
UNI-JET M6/12	12	9 / 13	18 / 20	130	1600	2800
UNI-JET M6/4	4	9 / 13	15 / 18	130	1600	2800
UNI-JET M6/150	12	9 / 13	18 / 20	150	1600	2800
UNI-JET M8/12	12	9 / 13	18 / 20	200	1700	2800
UNI-JET S	12	9 / 13	18 / 20	130	1600	2800

For all stated weights and dimensions, please refer to our application diagrams. For more information: [www.g-u.com](http://www.g-u.com)

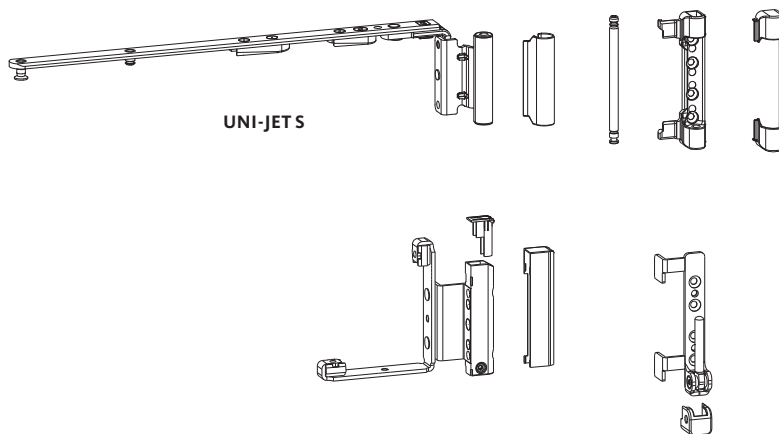

Rebate corner-hinge M8/12



Stay-bearing M6/12



Flexible cap



Stay-bearing S



Milling pattern UNI-JET M8/12



Milling pattern UNI-JET M6/12



Milling pattern UNI-JET M20/12



UNI-JETS installed

# The concealed hardware system for timber

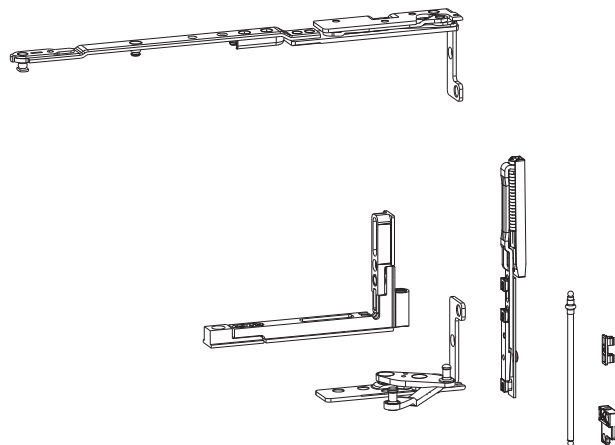

## UNI-JET SCF

No compromising on window design and function: with its fully concealed pivot-rests and stay-arms, the new UNI-JET SCF hardware lives up to the highest demands. The hardware is universally usable for timber windows with sash overlap, with CONTURA-compatible profile, and for flush timber windows.

### Design benefits

- The new turning-curve provides 5 mm free space on the frame, thus allowing for more design freedom
- No hardware components visible

### Easy handling

- No milling work necessary on the window
- One-man installation possible thanks to the parallel sash hinging
- No damage to components when plastering, as they are situated in the rebate area

### Possible applications

- Also with triple sashed "Swiss windows"
- Hardware load-bearing capacity tested up to 130 kg, with load-absorption set up to 160 kg
- Opening angle up to 90°



Flush appearance with 5 mm shadow gap for windows with sash overlap

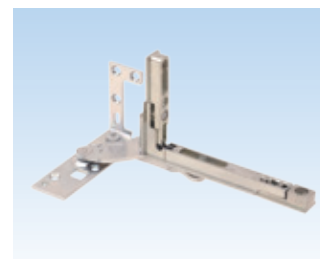

Pivot-rest



Timber window with CONTURA-compatible profile with 5 mm circumferential shadow gap



Windows with overlap allow for larger glass areas due to narrower frames

### Product overview

Description	Clearance [mm]	Axis [mm]	Sash overlap width [mm]	Tested hardware load-bearing capacity [kg]	Max. sash rebate width [mm]	Max. sash rebate height [mm]
UNI-JET SCF	12	9 / 13	max. 22	130	1400	2800
UNI-JET SCF	12	9 / 13	max. 22	160*	1400	2800

\* 160 kg with optional load-absorption set  
For all stated weights and dimensions, please refer to our application diagrams. For more information: [www.g-u.com](http://www.g-u.com)

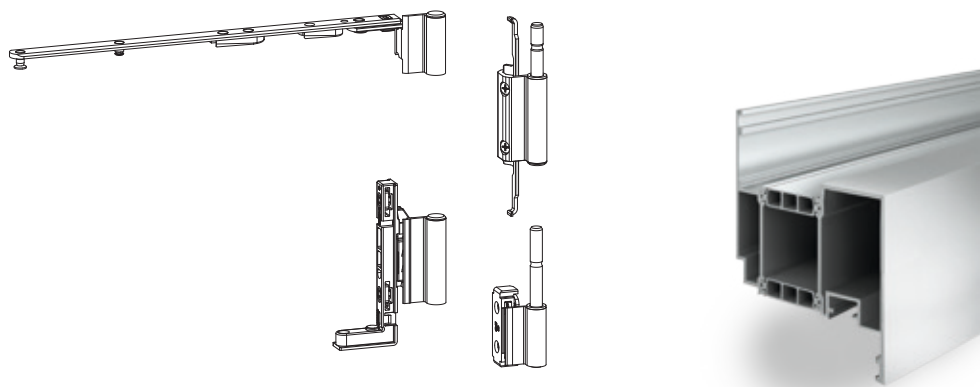

## UNI-JET C

With UNI-JET C for aluminium windows with 16 mm sash hardware groove, the GU Group makes it possible to create a harmonious overall image of both the hardware system and window. The hardware components are clamped to the frame.

### Design benefits

- Coherent aesthetically appealing design using an aluminium profile hinge flush with the sash overlap
- High-quality surface finish in anodised silver, white or black available from stock, an uncoated version is also available for project-related coating

### Easy handling

- Fabricator-friendly clamp fastening of the sash corner-hinge in the rear-cut hardware groove
- Convenient three-dimensional hardware adjustment

### Possible applications

- Sash rebate up to 1600 mm wide and 2800 mm high
- Hardware load-bearing capacity tested up to 130 kg



UNI-JET C



Pivot-rest



Stay-hinge and stay bearing

### Product overview

Description	Clearance [mm]	Axis [mm]	Sash overlap width [mm]	Tested hardware load-bearing capacity [kg]	Max. sash rebate width [mm]	Max. sash rebate height [mm]
UNI-JET C	12	9 / 13	18 / 20	130	1600	2800

For all stated weights and dimensions, please refer to our application diagrams. For more information: [www.g-u.com](http://www.g-u.com)

# The face-fixed hardware systems for aluminium

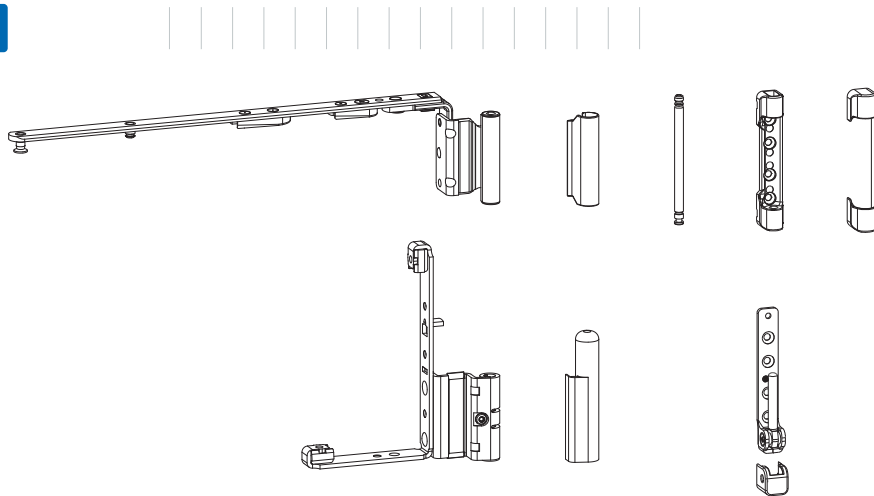

## UNI-JET D

The unpretentious elegance of the UNI-JET D hinge-side makes it an ideal match for the slimline profile design of aluminium windows. As it can also be used equally effectively for PVC windows, this significantly reduces storage overheads.

### Design benefits

- Cohesive elegant design
- High-quality surface available from stock in white and silver, additional colours available on request
- Cover caps available in a large selection of colours

### Easy handling

- Assembly-friendly pin safeguard in the stay-bearing
- Convenient three-dimensional hardware adjustment
- Stay bearing pin can be conveniently removed using the GU pull-handle or the GU adjustment tool, or a standard slotted screwdriver

### Possible applications

- A barrier-free version is available with higher positioned corner-hinges for balcony and patio doors with threshold
- Sash opening angle up to 180°



Rebate corner-hinge



Stay-bearing

### Product overview

Description	Clearance [mm]	Axis [mm]	Sash overlap width [mm]	Tested hardware load-bearing capacity [kg]	Max. sash rebate width [mm]	Max. sash rebate height [mm]
UNI-JET D	12	9 / 13	18 / 20	100	1600	2800

For all stated weights and dimensions, please refer to our application diagrams. For more information: [www.g-u.com](http://www.g-u.com)



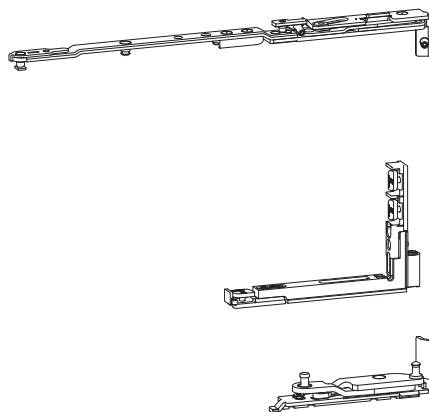

## UNI-JET CC

The UNI-JET CC hinge-side ensures a refined overall appearance of aluminium windows. The fully clampable hardware system with fully concealed pivot-rests and stay-arms is the right choice for aluminium windows with 16 mm sash hardware groove.

### Design benefits

- No hardware components visible

### Easy handling

- No machining necessary on the frame profile
- Installation without any drilling: modular, fully clampable hinge-side
- One-man installation possible thanks to the parallel sash hinging
- Suitable for flat or rear-cut 16 mm sash grooves
- Convenient three-dimensional hardware adjustment

### Possible applications

- Hardware load-bearing capacity tested up to 130 kg
- Opening angle up to 100°



Concealed hardware



View from inside

### Product overview

Description	Clearance [mm]	Axis [mm]	Sash overlap width [mm]	Tested hardware load-bearing capacity [kg]	Max. sash rebate width [mm]	Max. sash rebate height [mm]
UNI-JET CC	12	9 / 13	18 / 20 / 22	130	1400	2800

For all stated weights and dimensions, please refer to our application diagrams. For more information: [www.g-u.com](http://www.g-u.com)

# The face-fixed hardware system ALU-JET AK 8



## The ALU-JET AK 8 central locking system

The operation of the ALU-JET AK 8 central locking system is based on connecting rods and all components are compatible with the 15/20 aluminium sash Euro-groove.



# ALU-JET AK 8

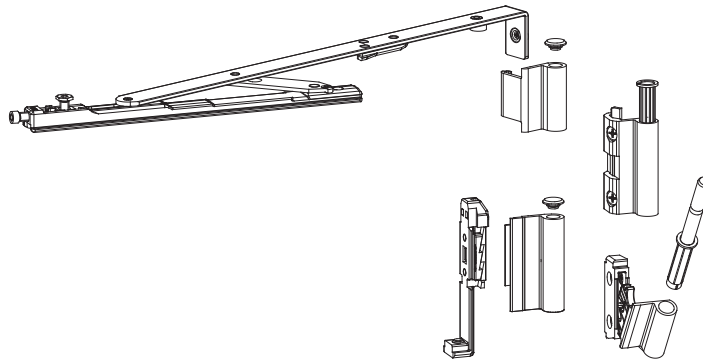

## ALU-JET AK 8

The aluminium window hardware with clamping installation technology for high-quality windows in commercial construction projects: all ALU-JET AK 8 face-fixed hinge components are made of anodised or powder-coated aluminium.

### Design benefits

- High-quality surface finish in anodised silver, white or black available from stock, an uncoated version is also available for project-related coating
- Identical aesthetics of pivot-rest and stay-hinge, flush with sash overlap

### Easy handling

- No machining necessary on the frame profile
- All components are compatible with the aluminium 15/20 sash Euro-groove and the 10/14, 12/15 or 14/18 frame groove
- The logical connecting-rod coupling system simplifies production steps during hardware installation
- The connecting-rod geometry is perfectly adapted to the 15/20 sash hardware-groove
- Convenient three-dimensional hardware adjustment
- Convenient operation thanks to the tried-and-tested SPACIO and ADAGIO-A geared-handles. Alternatively: insertable drive-gear & standard 7 mm spindle handles

### Possible applications

- Hardware load-bearing capacity tested up to 130 kg



Stay hinge and stay-bearing



Pivot-rest

### Product overview

Description	Clearance [mm]	Frame grooves [mm]	Tested hardware load-bearing capacity [kg]	Max. sash width [mm]	Max. sash height [mm]
ALU-JET AK 8	11.5	10/14 12/15 14/18	130	1700	2800

For all stated weights and dimensions, please refer to our application diagrams. For more information: [www.g-u.com](http://www.g-u.com)



## Production

### Germany:

Gretsch-Unitas GmbH  
Baubeschläge

BKS GmbH

GU Automatic GmbH

ela-soft GmbH

### France:

FERCO S.A.S.

### Slovak Republic:

GU SLOVENSKO, s.r.o.

### Canada:

FERRIC HARDWARE Inc.

## Sales

Albania

Argentina

Australia

Austria

Bahrain

Belgium

Bosnia-Herzegovina

Brazil

Bulgaria

Canada

Chile

China

Croatia

Cyprus

Czech Republic

Denmark

Estonia

Finland

France

Germany

Greece

Hungary

India

Indonesia

Iran

Ireland

Israel

Italy

Japan

Kazakhstan

Kuwait

Latvia

Lithuania

Macedonia

Malaysia

Mexico

Moldova

Netherlands

Norway

Oman

Poland

Portugal

Qatar

Romania

Russia

Saudi Arabia

Serbia

Singapore

Slovak Republic

Slovenia

South Korea

Spain

Sweden

Switzerland

Thailand

Turkey

United Kingdom

Ukraine

USA

United Arab

Emirates

Vietnam

Securing technology for you



# Systematic Service



## ConfIGUurator

The right products in the right quantity: the practical confiGUurator is an online platform where part lists and hardware sets can be precisely determined. The right products in the right quantity: the practical confiGUurator is an online platform where part lists and hardware sets can be precisely determined. The data is determined based on current conditions and fundamental technical principles.

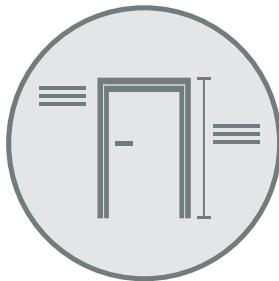

## Hardware data service

Individual, accurate and comprehensive: GU's hardware data service generates hardware master data as defined in our catalogues or according to the fabricator's individual requirements. As a result, the customer has access to project-specific hardware data with commercial and technical details.



## Tender-Text-Manager

Comprehensive, reliable and technically up-to-date: with the Tender-Text-Manager, the GU Group provides its customers with a convenient and effective online tool that allows them to effortlessly compile technical specifications and complete tender text specifications – for all of GU's products.

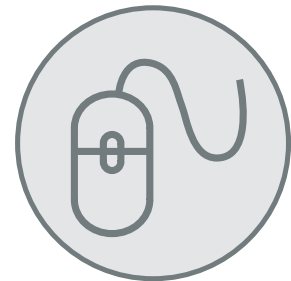

## Customer Information System

Available at the click of a mouse: the Customer Information System (CIS) is an ordering and information system for all of GU's products. Customers can use the online platform 24/7 to access important information: from preparing a quotation all the way through to carrying out an availability check in real time, and from placing an order through to tracking it down.



A product on its own is not a solution. The correct level of security, function and cost effectiveness can only be achieved with the right planning and by ensuring correct application. The GU Group therefore also applies the systematic thought processes demonstrated in its product range to its service offering. Close interlinking of one-to-one expert advice, free online support and a comprehensive programme of technical seminars aims to make the day-to-day work of customers easier.



### Order by Scanning (Obs)

The ordering system for streamlined logistics: Order by Scanning (Obs) is an easy-to-use scanner ordering system for recording requirements in production, warehouse and administration. The data is scanned via special barcode labels and transmitted to the GU Group directly online. The corresponding order number is displayed immediately and the status can be conveniently tracked online.



### Logistics

Saves space and time: with the flat and ergonomically-optimised UNI-JET Tilt&Turn hardware packaging, the GU Group ensures efficient storage and easy removal of components at the workplace. This makes day-to-day work processes faster and more efficient.

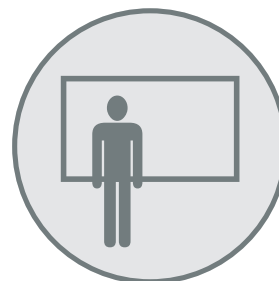

### Seminars and training courses

Practical knowledge based on first-hand experience: With around 160 events annually, the GU Group offers an extremely wide range of seminars and training courses. The programme includes product innovations and their applications, current architectural trends and standards and directives. Several seminars and training courses are certified and recognised as advanced training courses by the chamber of architects and civil engineers in Germany.

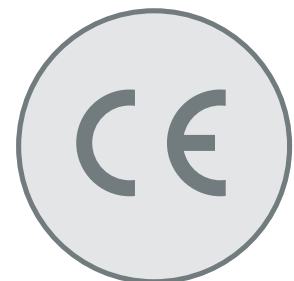

### Licences and CE

Maximum security as standard: The GU Group is a CE licensor for windows and balcony-doors and can undertake the CE certification on your behalf thus saving you time and effort in your day-to-day business.







WINDOW TECHNOLOGY  
DOOR TECHNOLOGY  
AUTOMATIC ENTRANCE SYSTEMS  
BUILDING MANAGEMENT SYSTEMS

Gretsch-Unitas GmbH  
Baubeschläge  
Johann-Maus-Str. 3  
71254 Ditzingen  
Germany  
Tel. +49 7156 301-0  
Fax +49 7156 301-77980

BKS GmbH  
Heidestr. 71  
42549 Velbert  
Germany  
Tel. +49 2051 201-0  
Fax +49 2051 201-9733

GU Automatic GmbH  
Karl-Schiller-Str. 12  
33397 Rietberg  
Germany  
Tel. +49 5244 9075-100  
Fax +49 5244 9075-599

[www.g-u.com](http://www.g-u.com)

Securing technology for you

